



COMMONWEALTH OF KENTUCKY  
TRANSPORTATION CABINET  
[www.transportation.ky.gov/](http://www.transportation.ky.gov/)

Andy Beshear  
GOVERNOR

Jim Gray  
SECRETARY

May 18, 2022

CALL NO. 364  
CONTRACT ID NO. 224313  
ADDENDUM # 1

Subject: Jefferson County, FD04 056 031E 014-016  
Letting May 26, 2022

- (1) Revised - Detail Sheets - Pages 51-54 of 117
- (2) Revised - Special Notes - Pages 56-57 of 117
- (3) Revised - Sheet - R108 - Page 72 of 117
- (4) Revised - Proposal Bid Items - Pages 116-117 of 117

Proposal revisions are available at <http://transportation.ky.gov/Construction-Procurement/>.

If you have any questions, please contact us at 502-564-3500.

Sincerely,

Rachel Mills,

A handwritten signature in cursive script that reads "Rachel Mills".

Rachel Mills, P.E.  
Director  
Division of Construction Procurement

RM:mr  
Enclosures

400 STREET PAVING AND APPURTENANCES

STANDARD PLAN NO 425A

REV DATE: NOV 2018

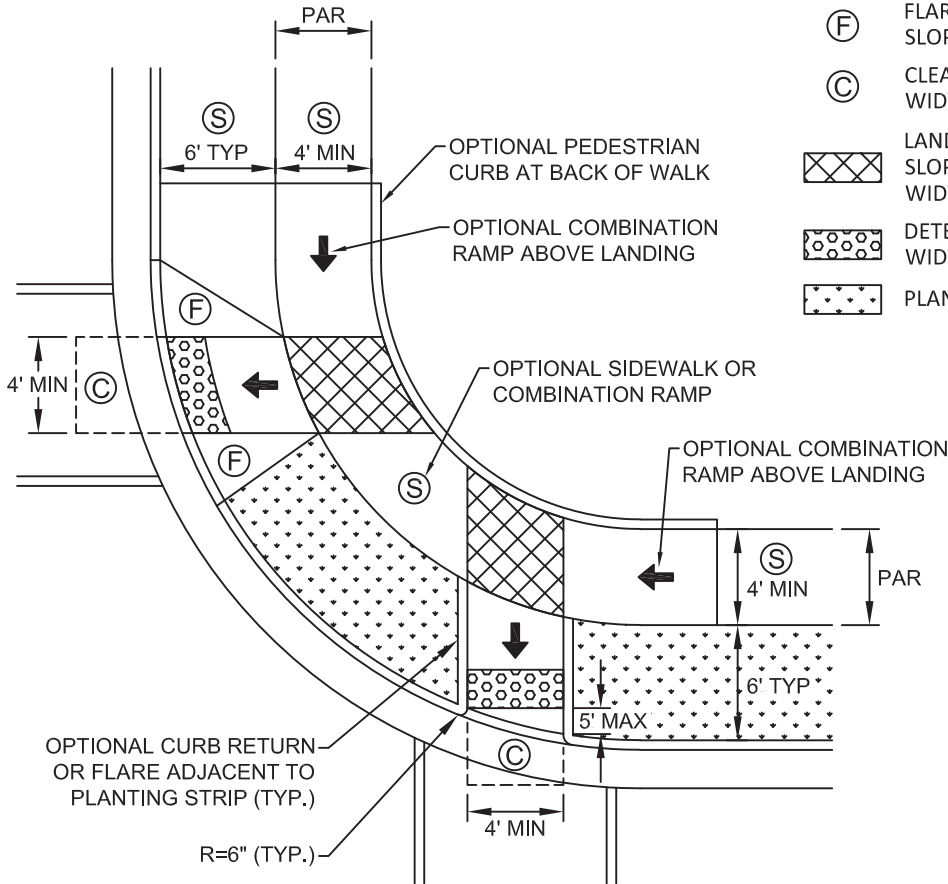

- ← RAMP  
RUNNING SLOPE 8.3% MAX (7.5% DESIGN)  
CROSS SLOPE 2% MAX (1.5% DESIGN)  
WIDTH 4' MIN
- (S) SIDEWALK  
RUNNING SLOPE 5% MAX OR STREET GRADE  
CROSS SLOPE 2% MAX (1.5% DESIGN)
- (F) FLARE  
SLOPE 10% MAX RELATIVE TO CURB LINE
- (C) CLEAR SPACE  
WIDTH 4' X 4' MIN
- [X-hatch] LANDING  
SLOPE 2% MAX (1.5% DESIGN) ANY DIRECTION  
WIDTH 4' X 4' MIN
- [Dotted-hatch] DETECTABLE WARNING  
WIDTH 2' MIN IN DIRECTION OF TRAVEL
- [Star-hatch] PLANTING STRIP

TYPE A - LARGE RADIUS

Apply notes 1-3 and 7-10 from KYTC Standard Drawing No. RPM-170-09.



LOUISVILLE METRO  
PUBLIC WORKS

NOT TO SCALE

CURB RAMP  
TYPE A

400 STREET PAVING AND APPURTENANCES

STANDARD PLAN NO 425C

REV DATE: NOV 2018

- ← RAMP  
RUNNING SLOPE 8.3% MAX (7.5% DESIGN)  
CROSS SLOPE 2% MAX (1.5% DESIGN)  
WIDTH 4' MIN
- Ⓢ SIDEWALK  
RUNNING SLOPE 5% MAX OR STREET GRADE  
CROSS SLOPE 2% MAX (1.5% DESIGN)
- ⓕ FLARE  
SLOPE 10% MAX RELATIVE TO CURB LINE
- ⓐ CLEAR SPACE  
WIDTH 4' X 4' MIN
- ▨ LANDING  
SLOPE 2% MAX (1.5% DESIGN) ANY DIRECTION  
WIDTH 4' X 4' MIN
- ⊙ DETECTABLE WARNING  
WIDTH 2' MIN IN DIRECTION OF TRAVEL
- ⋄ PLANTING STRIP

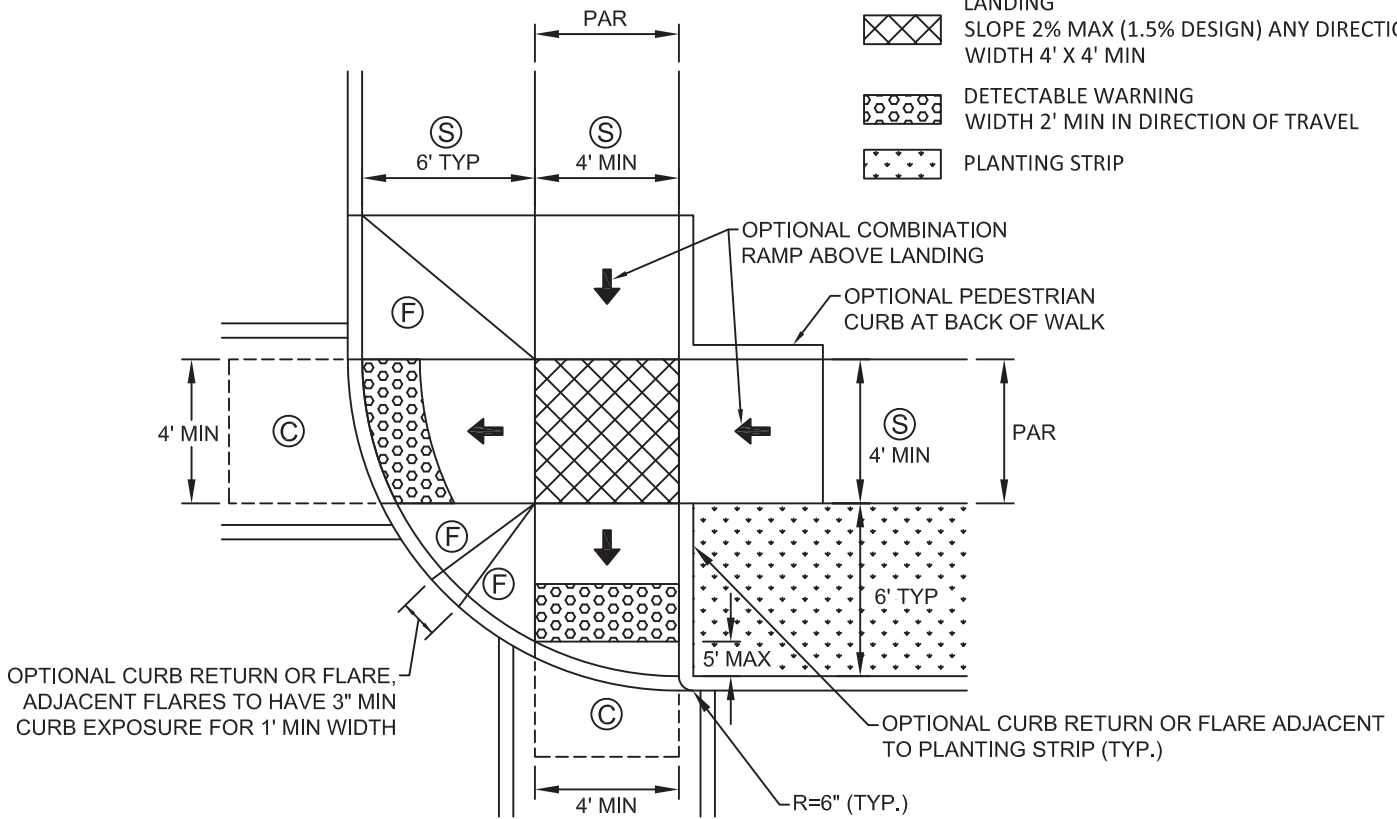

TYPE C - SMALL RADIUS

Apply notes 1-3 and 7-10 from KYTC Standard Drawing No. RPM-170-09.



LOUISVILLE METRO  
PUBLIC WORKS

NOT TO SCALE

CURB RAMP  
TYPE C

400 STREET PAVING AND APPURTENANCES

STANDARD PLAN NO 425D

REV DATE: NOV 2018

- ← RAMP  
RUNNING SLOPE 8.3% MAX (7.5% DESIGN)  
CROSS SLOPE 2% MAX (1.5% DESIGN)  
WIDTH 4' MIN
- Ⓢ SIDEWALK  
RUNNING SLOPE 5% MAX OR STREET GRADE  
CROSS SLOPE 2% MAX (1.5% DESIGN)
- ▣ LANDING  
SLOPE 2% MAX (1.5% DESIGN) ANY DIRECTION  
WIDTH 4' X 4' MIN
- ◉ DETECTABLE WARNING  
WIDTH 2' MIN IN DIRECTION OF TRAVEL

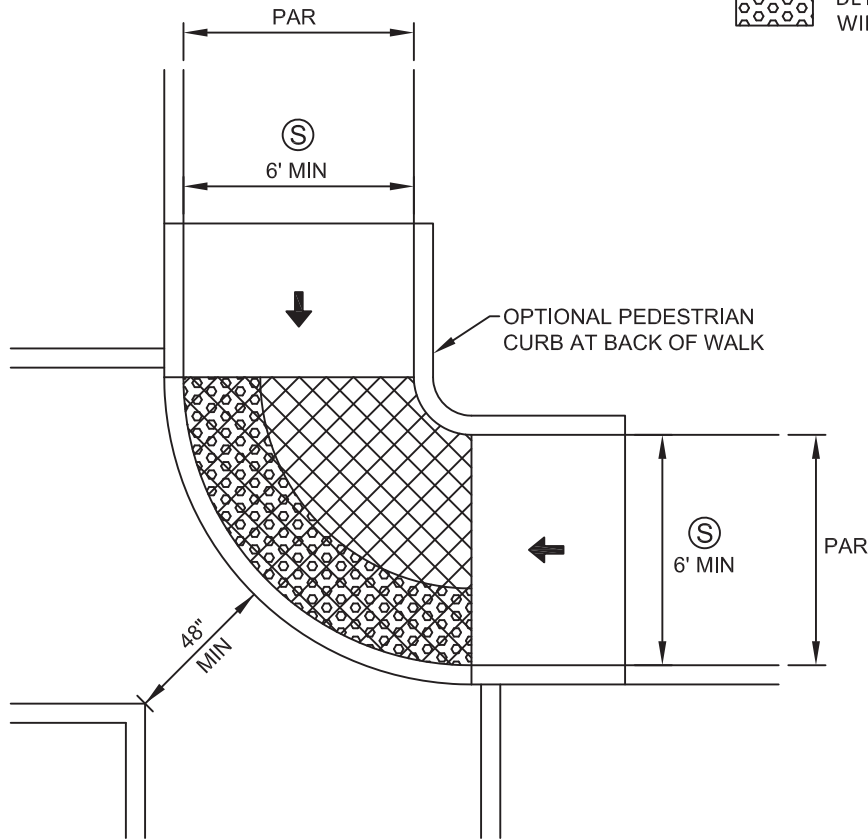

TYPE D - SMALL RADIUS AT BACK OF CURB

Apply notes 1-3 and 7-10 from KYTC Standard Drawing No. RPM-170-09.



LOUISVILLE METRO  
PUBLIC WORKS

NOT TO SCALE

CURB RAMP  
TYPE D

400 STREET PAVING AND APPURTENANCES

STANDARD PLAN NO 425F

REV DATE: NOV 2018

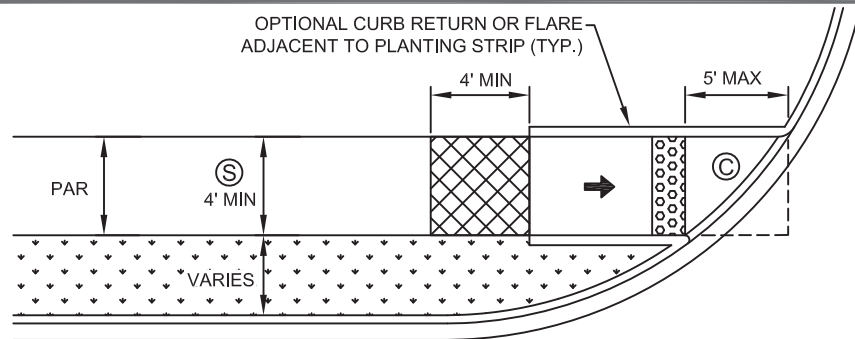

TYPE F1 - DIRECTIONAL WITH PLANTING STRIP

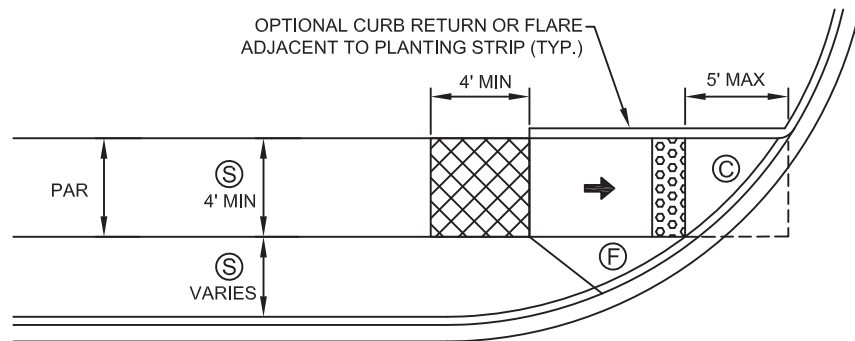

TYPE F2 - DIRECTIONAL WITH UTILITY STRIP

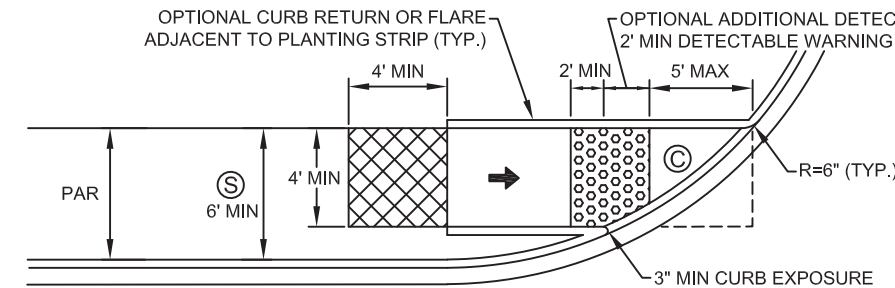

TYPE F3 - DIRECTIONAL AT BACK OF CURB

- ← RAMP  
RUNNING SLOPE 8.3% MAX (7.5% DESIGN)  
CROSS SLOPE 2% MAX (1.5% DESIGN)  
WIDTH 4' MIN
- Ⓢ SIDEWALK  
RUNNING SLOPE 5% MAX OR STREET GRADE  
CROSS SLOPE 2% MAX (1.5% DESIGN)
- ⓕ FLARE  
SLOPE 10% MAX RELATIVE TO CURB LINE
- ⓐ CLEAR SPACE  
WIDTH 4' X 4' MIN
- ▨ LANDING  
SLOPE 2% MAX (1.5% DESIGN) ANY DIRECTION  
WIDTH 4' X 4' MIN
- ⦿ DETECTABLE WARNING  
WIDTH 2' MIN IN DIRECTION OF TRAVEL
- ⋯ PLANTING STRIP

Apply notes 1-3 and 7-10 from KYTC Standard Drawing No. RPM-170-09.



LOUISVILLE METRO  
PUBLIC WORKS

NOT TO SCALE

CURB RAMP  
TYPE F

REVISED 5/18/22

ITEM CODE	ITEM	UNIT	MAINTLINE	SECONDARY	ENTRANCES	APPROACHES	TEMPORARY	TOTAL PROJECT
324	CL3 ASPH SURF 0.50B PG64-22	TON	3361					3361
190	LEVELING & WEDGING PG64-22	TON	168					168

ITEM	PAVING AREA					TOTALS
	MAINTLINE	SECONDARY	ENTRANCES	APPROACHES	TEMPORARY	
324	CL3 ASPH SURF 0.50B PG64-22	40,743				40,743
20018EN	ASPHALT MILLING AND TEXTURING	40,743				40,743

MILL DEPTH IS 1.5" AVERAGE AND SURFACING DEPTH IS 1.5" AVERAGE OF CL3 ASPH SURF 0.38B, PG 64-22. CONSIDER THESE DIMENSIONS FOR PAVEMENT THICKNESSES TO BE NOMINAL OR TYPICAL DIMENSIONS. IN ADDITION TO LEVELING AND WEDGING, THE ENGINEER MAY DIRECT OR APPROVE VARYING THE ACTUAL DIMENSIONS TO BE CONSTRUCTED TO FIT EXISTING CONDITIONS.

STA.	INTERSECTION	APPROACHES	NO. OF LOOPS	TRAFFIC LOOPS SUMMARY				CONDUIT 1 1/4 INCH	OPEN CUT	CABLE 1 1/4 INCH	JUNCTION BOX 1 1/4 INCH	REMOVE & REPAIR SIGNAL CABINET
				LOOPS	SAW SLOT & FILL	SAW SLOT & FILL	LOOPS					
54+08	EASTERN PARKWAY	NB/ SB LEFTS	2	075	270	10	10	250	1	1	3	2
54+22	LONGST AVENUE	SB LEFTS & SS	2	200	280	10	10	275	1	1	3	2
54+46	MID CITY WALL ENTRANCE	NB LEFT	1	350	140	10	10	350	1	1	3	1
54+51	GRINSTEAD DRIVE	NB/ SB LEFTS & SS	6	1800	790	20	20	350	2	2	5	6
07+10	BAXTER AVENUE/ HUNTSVILLE	NB/ SB LEFTS & SS	6	2000	800	10	10	175	1	1	4	6
14+00	WINDYBROOK/ CHESTER ROAD	NB LEFT/ THRU	2	725	280				6	6	15	19
<b>TOTALS</b>			<b>19</b>	<b>6350</b>	<b>2530</b>	<b>60</b>	<b>60</b>	<b>1100</b>	<b>6</b>	<b>6</b>	<b>15</b>	<b>19</b>

TRAFFIC LOOPS SUMMARY NOTES:  
 1. SEE SPECIAL NOTE FOR TRAFFIC SIGNAL LOOP DETECTORS FOR ADDITIONAL INFORMATION.  
 2. COORDINATE SIGNAL LOOP LOCATIONS WITH THE PROJECT ENGINEER & DISTRICT 5 TRAFFIC ENGINEER.  
 3. QUANTITIES ARE FOR ESTIMATING PURPOSES ONLY AND ARE ALSO INCLUDED IN THE ADJACENT GENERAL SUMMARY TABLE. FIELD MEASURE AND INSPECT ITEMS TO VERIFY QUANTITIES.  
 4. TWO 1 1/4-INCH CONDUITS MAY BE USED IN LIEU OF A 2-INCH CONDUIT. FIELD VERIFY CONDUIT TO MATCH EXISTING FACILITIES TO TIE-IN TO POLES OR CABINETS.  
 5. ONLY REPLACE EXISTING CONDUIT IF MISSING AND/OR DAMAGED.  
 6. INSTALL NEW LEFT TURN LOOPS & JUNCTION BOXES AS DIRECTED BY DS. TRAFFIC 5 (OR LOUISVILLE METHOD ELECTRICAL). SPlice LOOP WIRE TO NEW 14/1 PAIR CABLE AND RUN 14/1 PAIR TO THE CABINET. COIL 3' OF 14/1 PAIR CABLE IN THE CABINET AND LABEL ALL WIRES.

ITEM	DESCRIPTION	BID ITEM #	UNIT	MAINTLINE	APPROACH	ENTRANCE	TOTAL PROJECT
1719	ADJUST INLET		EACH	1			1
1720	RECONSTRUCT INLET		EACH	2			2
1732	ADJUST MANHOLE		EACH	10			10
1810	STANDARD CURB AND GUTTER		LF	24			24
1835	STANDARD HEADER CURB		LF	1107			1107
1894	REMOVE CURB		LF	50			50
2200	ROADWAY EXCAVATION		CYD	124			124
2460	REMOVE TREES OR STUMPS		EACH	1			1
2562	TEMPORARY SIGNS		SOFT	790			790
2568	MOBILIZATION		LS	1			1
2569	DEMOBILIZATION		LS	1			1
2621	PORTABLE CHANGEABLE MESSAGE SIGN		EACH	2			2
2676	REGULATION FOR RAILS & TEXT		LS	1			1
2677	ASPHALT PAVE MILLING & TEXTURING		TON	2363			2363
2720	REMOVE CONCRETE SIDEWALK		SOVD	651			651
2721	REMOVE CONCRETE SIDEWALK		SOVD	65			65
2726	STAKING		LS	1			1
2775	ADJUST WATER VALVE		EACH	15			15
3425	CONDUIT 1 1/4 IN		LF	244			244
4811	ELECTRICAL JUNCTION BOX TYPE B		EACH	10			10
4821	OPEN CUT ROADWAY		LF	244			244
4830	LOOP WIRE		LF	6350			6350
4850	CABLE - NO. 14/1 PAIR		LF	1100			1100
4882	SIGNAL PEDESTAL		EACH	3			3
4895	LOOP SAW SLOT AND FILL		LF	2530			2530
4952	LOOP MULCH		SOVD	282			282
4959	REMOVE EXISTENT TAMBER TYPE Y		EACH	280			280
5000S	PILE ADJUSTMENT		SOVD	5520			5520
5000NS	ASPHALT ADJUSTMENT		SOVD	13863			13863
50071FC	JOINT ADHESIVE		LF	76000			76000
20550ND	SAW CUT		LF	1138			1138
23158ES	DETECTABLE WARNINGS - RETROFIT		SOFT	482			482
23258EC	INSTALL PRECAST POST		EACH	1			1
24896EC	SIDEWALK IN CONCRETE		CYD	34			34
24968ED	LOOP TEST		EACH	19			19
25071ED	ASPHALT MATERIAL FOR TRACK MARKING		TON	17			17
25071ED	SIDEWALK UNDERDRAIN		EACH	46			46

- \*BID ITEM NOTES
- 1720, 1810, 1835, 2720, 24890EC, 25071ED - HISTORIC CONCRETE MIX PROVIDE A CLASS A CONCRETE MIX CONFORMING TO KENTUCKY STANDARD SPECIFICATION SECTION 601 WITH THE FOLLOWING EXCEPTIONS:  
 - APPROVED CLASS A AGGREGATE SHALL BE RIVER GRAVEL, THE COURSE AGGREGATE SHALL BE AT LEAST 50% OF THE TOTAL AGGREGATE IN THE COURSE.  
 - ACHIEVE A "HISTORIC" WEATHERED FINISH BY USE OF A WATER BASE PIGMENTED, TOP SURFACE RETARDER RESULTING IN A SURFACE DEPTH ETCH OF UP TO 1/8 INCH. APPLY AND REMOVE THE SURFACE RETARDER IN ACCORDANCE WITH MANUFACTURER'S RECOMMENDATIONS.  
 - PLACEMENT AND REMOVAL OF THE SURFACE RETARDER SHALL BE CONSIDERED INCIDENTAL TO THE PLACED CONCRETE.
  - 4793 - INCLUDE PULL STRINGS AND CAP ALL ENDS.
  - 4882 - PROVIDE TEMPORARY CAP AT TOP OF POST TO PREVENT WATER INTRUSION. WIRING, FUSES, DETECTORS, SIGNS, AND SIGNALS WILL BE INSTALLED BY OTHERS. IF FOUNDATION OR POLE TRANSFORMER BASE DIAMETER IS GREATER THAN 2', COORDINATE RELOCATION WITH ENGINEER.
  - 40024, 2720 - WHEN SPECIFIED FOR TREE PLANTERS, REMOVAL IS ESTIMATED AT \$45,500 PER CONNECTION AND WIDE AND PAY IS BASED ON MEASUREMENT APPROVED BY ENGINEER. DO NOT DAMAGE ADJACENT SIDEWALK STAIRS, SUPPORT AND STAIRS THAT ARE NOT SUPPORTED WITH ENGINEER APPROVAL.
  - 23235EC - WIRING, FUSES, DETECTOR, AND SIGN WILL BE INSTALLED BY OTHERS. IF FOUNDATION OR POLE TRANSFORMER BASE DIAMETER IS GREATER THAN 15', COORDINATE RELOCATION WITH ENGINEER.
  - 25071ED - DESIGN BASED ON NEEMAH 4-4994-HB TYPE 'S' FRAME. SUBSTITUTION OF PRODUCT MUST BE APPROVED BY ENGINEER.



ITEM NO. 05-0003000 COUNTY OF JEFFERSON  
 SHEET NO. R002

GENERAL, PAVING, AND TRAFFIC LOOPS SUMMARIES

REVISED 5/18/22

ITEM NO. 05-0003000  
SHEET NO. R003  
COUNTY OF JEFFERSON

**GENERAL NOTES**

1. REPAIR BROKEN HEADER CURB ADJACENT TO PROPOSED CURB AND GUTTER. PAYMENT WILL BE THROUGH ITEMS 1875 AND 1904 WITH ENGINEERS APPROVAL.
2. ENSURE THERE IS NO PONDING AT PROPOSED PED RAMPS.
3. THE TYPICAL SECTION IS A 4' OR PAVEMENT WIDTH BETWEEN THE EXISTING CURBS WITH ONE 18" LANE ONE 3' BUFFER AND ONE 8' WIDE PARALLEL PARKING SPACE IN EACH DIRECTION. CONSIDER THESE DIMENSIONS TO BE NOMINAL OR TYPICAL DIMENSIONS. THE ENGINEER MAY DIRECT OR APPROVE VARYING THE ACTUAL DIMENSIONS TO BE CONSTRUCTED TO FIT EXISTING CONDITIONS. DO NOT WIDEN EXISTING PAVEMENT OR SHOULDERS UNLESS SPECIFIED ELSEWHERE IN THE PLANS OR DIRECTED BY THE ENGINEER.
4. COORDINATE WITH ENGINEERS BEFORE ANY WORK BEGINS AT THE CURB EXTENSIONS AND TREE WELLS. A DIFFERENT PAVEMENT MATERIAL MAY BE SPECIFIED. **EXISTING CURB AND GUTTER SHALL BE MAINTAINED WITH THE EXISTING SURFACE MATERIALS AND ALL EXISTING CURB SHALL BE MAINTAINED.**
5. KEEP PROPOSED MIDBLOCK AND SIGNALIZED CROSSWALKS CLOSED PER KYTC AND MUTCD TRAFFIC CONTROL STANDARDS UNTIL DIRECTED BY KYTC TO OPEN THEM.
6. DATES THAT LANE CLOSURES ARE NOT PERMITTED INCLUDE BUT ARE NOT LIMITED TO:  
 - EASTER WEEKEND (11/23/22-11/27/22), CHRISTMAS WEEKEND (12/23/22-12/26/22), NEW YEAR'S WEEKEND (12/30/22-1/2/23), EASTER WEEKEND (4/7/23-4/9/23), THUNDER OVER LOUISVILLE (4/21/23-4/23/23), AND KENTUCKY DERBY WEEKS (4/24/23-5/7/23).
7. CONSTRUCTION HOURS AND RESTRICTIONS FOR THE PROJECT INCLUDE BUT ARE NOT LIMITED TO:  
 - LANE CLOSURES & MOBILE OPERATIONS ARE PERMITTED SUNDAY THROUGH THURSDAY NIGHTS FROM 8 PM - 5 AM  
 - NIGHT WORK, MILLING AND RESURFACING ACTIVITIES AT NIGHT. OBTAIN ENGINEERS APPROVAL OF THE LIGHTING METHOD PRIOR TO PERFORMING NIGHT WORK.  
 - MOB-MILLING AND RESURFACING ACTIVITIES MAY OCCUR DURING ALL DAYLIGHT HOURS. IF CONTAINED WITHIN AN EXISTING PARKING LANE.  
 - THE ENGINEER MAY PERMIT OPERATIONS THAT CAUSE MINOR DISRUPTION TO TRAFFIC BETWEEN THE HOURS OF 9 AM TO 3 PM.
8. SEE THE TRAFFIC CONTROL PLAN DOCUMENT INCLUDED IN THE CONTRACT DOCUMENTS FOR ADDITIONAL LANE CLOSURE AND TRAFFIC CONTROL DETAILS.
9. **RESURFACING PROJECT CONTRACT 22-2080 IS ADJACENT TO THIS PROJECT. CONTRACT 22-2080 WILL START AT THE NORTHERN LIMIT AT APPROXIMATE MILEPOST 15.0. CONTRACT 22-2080 WILL BE COMPLETED BY THE END OF THE PROJECT. CONTRACT 22-2080 WILL BE COMPLETED BY THE END OF THE PROJECT. CONTRACT 22-2080 WILL BE COMPLETED BY THE END OF THE PROJECT. CONTRACT 22-2080 WILL BE COMPLETED BY THE END OF THE PROJECT.**

**SPECIAL NOTES FOR STAKING**

- PERFORM CONTRACTOR STAKING ACCORDING TO SECTION 201, EXCEPT, IN ADDITION TO THE REQUIREMENTS OF SECTION 201, PERFORM THE FOLLOWING:
1. CONTRARY TO SECTION 201.03.01, PERFORM ITEMS 1 & 2 USUALLY PERFORMED BY THE ENGINEER.
  2. USING PAINT MARKS ON THE PAVEMENT AND/OR ANY OTHER MEANS APPROVED BY THE ENGINEER, THE CONTRACTOR SHALL LAYOUT AND PRE-MARK THE PROPOSED STAKING LOCATIONS. THE CONTRACTOR SHALL PROVIDE ACCESS TO ALL STAKING LOCATIONS. THE CONTRACTOR SHALL PROVIDE PROPER ALIGNMENT OF THE PROPOSED TURNING STRIPES AND APPROVAL OF THE ENGINEER PRIOR TO INSTALLING THE STRIPING AND/OR PAVEMENT MARKINGS.
  3. AFTER STAKING OUT THE PROPOSED WORK AND/OR LAYING OUT THE PROPOSED STRIPING, DETERMINE IF THERE ARE ANY EXISTING SIGNS THAT REQUIRE REMOVAL AND/OR RELOCATION. PROVIDE THE DISTRICT TRAFFIC ENGINEER WITH 2 WEEKS OF NOTICE WHEN A ROUTE WILL BE READY FOR A REVIEW OF THE STAKED LOCATIONS.
  4. PRIOR TO INCORPORATING INTO THE WORK, OBTAIN THE ENGINEERS APPROVAL OF ALL REVISIONS DETERMINED BY THE CONTRACTOR.
  5. PERFORM ANY AND ALL OTHER STAKING OPERATIONS REQUIRED TO CONTROL AND CONSTRUCT THE WORK.

**GENERAL NOTES**



COMMONWEALTH OF KENTUCKY  
DEPARTMENT OF HIGHWAYS

OpenRoads Designer 7.10.16.0300

DATE PLOTTED: 9/17/2025 7:58:02 PM

USER: jared.greene

FILE NAME: C:\WORK\KENTY\AREDCGREENED\0500000\_00030\_014\_GENERAL\_NOTES.DGN

REVISED 5/16/2024

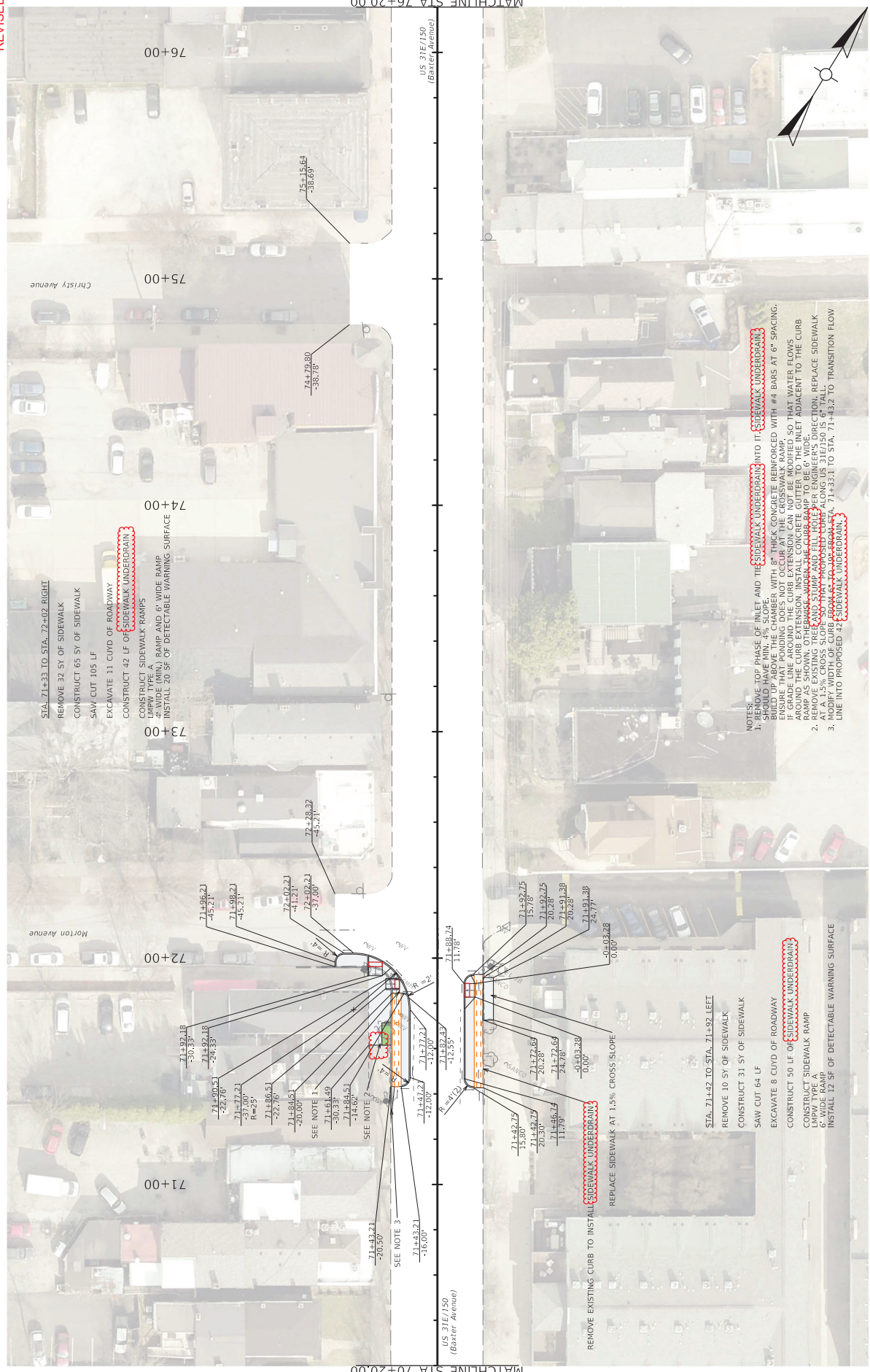

STA 71+33 TO STA 72+02 RIGHT  
REMOVE 32 SY OF SIDEWALK  
CONSTRUCT 65 SY OF SIDEWALK  
SAW CUT 105 LF  
EXCAVATE 11 CUYD OF ROADWAY  
CONSTRUCT 42 LF OF SIDEWALK UNDERDRAIN  
LAMPY TYPE A  
INSTALL 20 SF OF DETECTABLE WARNING SURFACE

STA 71+42 TO STA 71+92 LEFT  
REMOVE 10 SY OF SIDEWALK  
CONSTRUCT 31 SY OF SIDEWALK  
SAW CUT 64 LF  
EXCAVATE 8 CUYD OF ROADWAY  
CONSTRUCT 50 LF OF SIDEWALK UNDERDRAIN  
LAMPY TYPE A  
INSTALL 12 SF OF DETECTABLE WARNING SURFACE

NOTES:  
1. REMOVE TOP PHASE OF INLET AND THE SIDEWALK UNDERDRAIN INTO IT SIDEWALK UNDERDRAIN SHOULD HAVE MIN. 4% SLOPE WITH 6" THICK CONCRETE REINFORCED WITH #4 BARS AT 6" SPACING. IF GRADE LINE AROUND THE CURB EXTENSION CAN NOT BE MODIFIED SO THAT WATER FLOWS AWAY FROM THE CURB, THE CURB EXTENSION SHOULD BE ADJACENT TO THE CURB RAMP AS SHOWN. OTHERWISE WIDEN THE CURB RAMP TO BE 6' WIDE.  
2. REMOVE EXISTING TREE AND STUMP AND FILL HOLE PER ENGINEER'S DIRECTION. REPLACE SIDEWALK UNDERDRAIN WITH NEW UNDERDRAIN. ALLOW US TO INSTALL UNDERDRAIN FROM STA 71+33.1 TO STA 71+43.2 TO TRANSITION FLOW LINE INTO PROPOSED 42' SIDEWALK UNDERDRAIN.  
3. MODIFY WIDTH OF CURB FROM 6' TO 8' TO ACCOMMODATE 42' SIDEWALK UNDERDRAIN.

ITEM NO. 05-00000000  
SHEET NO. R018

STA. 70+20 TO STA. 76+20



HORIZONTAL SCALE  
SCALE: 1" = 20'

PLAN SHEET



COMMONWEALTH OF KENTUCKY  
DEPARTMENT OF HIGHWAYS



**PROPOSAL BID ITEMS**

224313

Page 1 of 2

Report Date 5/18/22

**Section: 0001 - PAVING**

LINE	BID CODE	ALT	DESCRIPTION	QUANTITY	UNIT	UNIT PRIC	FP	AMOUNT
0010	00190		LEVELING & WEDGING PG64-22	168.00	TON		\$	
0020	00388		CL3 ASPH SURF 0.38B PG64-22	3,361.00	TON		\$	
0030	02676		MOBILIZATION FOR MILL & TEXT (JEFFERSON US 31E)	1.00	LS		\$	
0040	02677		ASPHALT PAVE MILLING & TEXTURING	3,361.00	TON		\$	
0050	20071EC		JOINT ADHESIVE	26,000.00	LF		\$	
0060	24970EC		ASPHALT MATERIAL FOR TACK NON- TRACKING	17.00	TON		\$	

**Section: 0002 - ROADWAY**

LINE	BID CODE	ALT	DESCRIPTION	QUANTITY	UNIT	UNIT PRIC	FP	AMOUNT
0070	01719		ADJUST INLET	1.00	EACH		\$	
0080	01720		RECONSTRUCT INLET	2.00	EACH		\$	
0090	01792		ADJUST MANHOLE	10.00	EACH		\$	
0100	01810		STANDARD CURB AND GUTTER	24.00	LF		\$	
0110	01875		STANDARD HEADER CURB	1,107.00	LF		\$	
0120	01904		REMOVE CURB	50.00	LF		\$	
0130	02200		ROADWAY EXCAVATION	124.00	CUYD		\$	
0140	02460		REMOVE TREES OR STUMPS	1.00	EACH		\$	
0150	02562		TEMPORARY SIGNS	790.00	SQFT		\$	
0160	02650		MAINTAIN & CONTROL TRAFFIC (JEFFERSON US 31E)	1.00	LS		\$	
0170	02671		PORTABLE CHANGEABLE MESSAGE SIGN	2.00	EACH		\$	
0180	02720		SIDEWALK-4 IN CONCRETE	651.00	SQYD		\$	
0190	02726		STAKING (JEFFERSON US 31E)	1.00	LS		\$	
0200	02775		ARROW PANEL	4.00	EACH		\$	
0210	03425		ADJUST WATER VALVE	15.00	EACH		\$	
0220	05952		TEMP MULCH	282.00	SQYD		\$	
0230	06510		PAVE STRIPING-TEMP PAINT-4 IN	40,000.00	LF		\$	
0240	06514		PAVE STRIPING-PERM PAINT-4 IN	500.00	LF		\$	
0250	06531		PAVE STRIPING REMOVAL-6 IN	210.00	LF		\$	
0260	06542		PAVE STRIPING-THERMO-6 IN W	8,350.00	LF		\$	
0270	06546		PAVE STRIPING-THERMO-12 IN W (WET REFLECTIVE)	330.00	LF		\$	
0280	06565		PAVE MARKING-THERMO X-WALK-6 IN	3,740.00	LF		\$	
0290	06565		PAVE MARKING-THERMO X-WALK-6 IN (WET REFLECTIVE)	160.00	LF		\$	
0300	06568		PAVE MARKING-THERMO STOP BAR-24IN	790.00	LF		\$	
0310	06569		PAVE MARKING-THERMO CROSS-HATCH	2,610.00	SQFT		\$	
0320	06573		PAVE MARKING-THERMO STR ARROW	3.00	EACH		\$	
0330	06574		PAVE MARKING-THERMO CURV ARROW	29.00	EACH		\$	
0340	06575		PAVE MARKING-THERMO COMB ARROW	9.00	EACH		\$	
0350	06576		PAVE MARKING-THERMO ONLY	13.00	EACH		\$	
0360	06600		REMOVE PAVEMENT MARKER TYPE V	300.00	EACH		\$	
0370	10020NS		FUEL ADJUSTMENT	5,520.00	DOLL	\$1.00	\$	\$5,520.00

**PROPOSAL BID ITEMS**

224313

Page 2 of 2

Report Date 5/18/22

LINE	BID CODE	ALT	DESCRIPTION	QUANTITY	UNIT	UNIT PRIC	FP	AMOUNT
0380	10030NS		ASPHALT ADJUSTMENT	13,863.00	DOLL	\$1.00	\$	\$13,863.00
0390	20550ND		SAWCUT PAVEMENT	1,138.00	LF		\$	
0400	21417ES717		PAVE MARK THERMO CONE CAP-SOLID YELLOW	6.00	SQFT		\$	
0410	22520EN		PAVE MARKING-THERMO YIELD BAR-36 IN (WET REFLECTIVE)	80.00	LF		\$	
0420	23158ES505		DETECTABLE WARNINGS (NEW)	482.00	SQFT		\$	
0430	23158ES505		DETECTABLE WARNINGS (RETROFIT)	122.00	SQFT		\$	
0440	23261EC		PAVE MARK-THERMO-X-WALK-24 IN	2,130.00	LF		\$	
0450	23261EC		PAVE MARK-THERMO-X-WALK-24 IN (WET REFLECTIVE)	150.00	LF		\$	
0460	02721		REMOVE CONCRETE SIDEWALK (REVISED 5-18-22)	65.00	SQYD		\$	
0470	23928EC		PAVE MARK-THERMO "BUS" 8 FT	13.00	EACH		\$	
0480	24683ED		PAVE MARKING-THERMO DOTTED LANE EXTEN (WET REFLECTIVE)	1,270.00	LF		\$	
0490	24890EC		SIDEWALK-8 IN CONCRETE	14.00	SQYD		\$	
0500	25008EC		PAVE STRIPING-THERMO-6 IN W-WET REFLECT	13,820.00	LF		\$	
0510	25009EC		PAVE STRIPING-THERMO-6 IN Y-WET REFLECT	14,320.00	LF		\$	
0520	25071ED		SIDEWALK UNDERDRAIN	46.00	EACH		\$	

**Section: 0003 - SIGNALIZATION**

LINE	BID CODE	ALT	DESCRIPTION	QUANTITY	UNIT	UNIT PRIC	FP	AMOUNT
0530	04793		CONDUIT-1 1/4 IN	244.00	LF		\$	
0540	04811		ELECTRICAL JUNCTION BOX TYPE B	10.00	EACH		\$	
0550	04821		OPEN CUT ROADWAY	244.00	LF		\$	
0560	04830		LOOP WIRE	6,350.00	LF		\$	
0570	04850		CABLE-NO. 14/1 PAIR	1,100.00	LF		\$	
0580	04882		SIGNAL PEDESTAL	3.00	EACH		\$	
0590	04895		LOOP SAW SLOT AND FILL	2,530.00	LF		\$	
0600	23235EC		INSTALL PEDESTAL POST	1.00	EACH		\$	
0610	24963ED		LOOP TEST	19.00	EACH		\$	

**Section: 0004 - DEMOBILIZATION &/OR MOBILIZATION**

LINE	BID CODE	ALT	DESCRIPTION	QUANTITY	UNIT	UNIT PRIC	FP	AMOUNT
0620	02568		MOBILIZATION	1.00	LS		\$	
0630	02569		DEMOBILIZATION	1.00	LS		\$	